



HYDRAULICS

# CEJN Multi-X

*– Flexible multi connections for quick and easy handling*



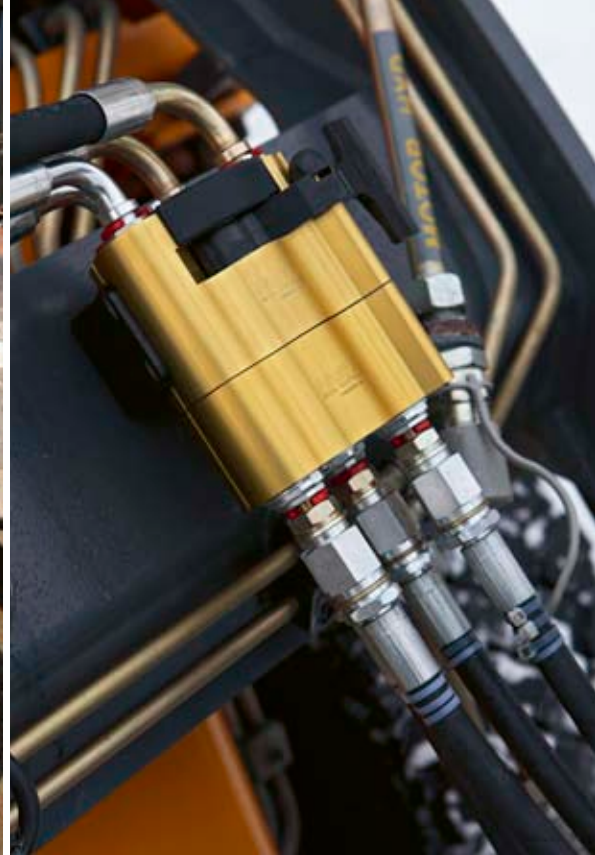

**CEJN Multi-X allows you to**

- Minimize downtime during tool changes
- Connect the hydraulic lines with residual pressure
- Install multi-plates in confined spaces
- Use working pressure up to 5076 PSI (350 bar)
- Eliminate cross connection



# Multiple connections in one step with CEJN's Multi-X range

*– Advanced technology made easy*

CEJN Multi-X is a range of innovative, easy to handle, multi-plates designed to meet and exceed the demands of even the most challenging mobile hydraulic application. Its innovative design rivals and surpasses other existing multi-plates on the market. The unique design made with the user in mind offers you a plate system that provides great flexibility, high performance, easy installation and trouble-free operation.

EASY TO  
MANEUVER

ENVIRONMENT FRIENDLY  
FLAT-FACE CONNECTIONS

CONNECTABLE  
UNDER PRESSURE

TORSION FREE  
CONNECTORS

FLEXIBLE  
INSTALLATION

SMALL SPACE  
REQUIREMENTS

# Arguments for Multi-X

Single ISO 16028 Flat-Face couplings can be used with fixed installed male plates.

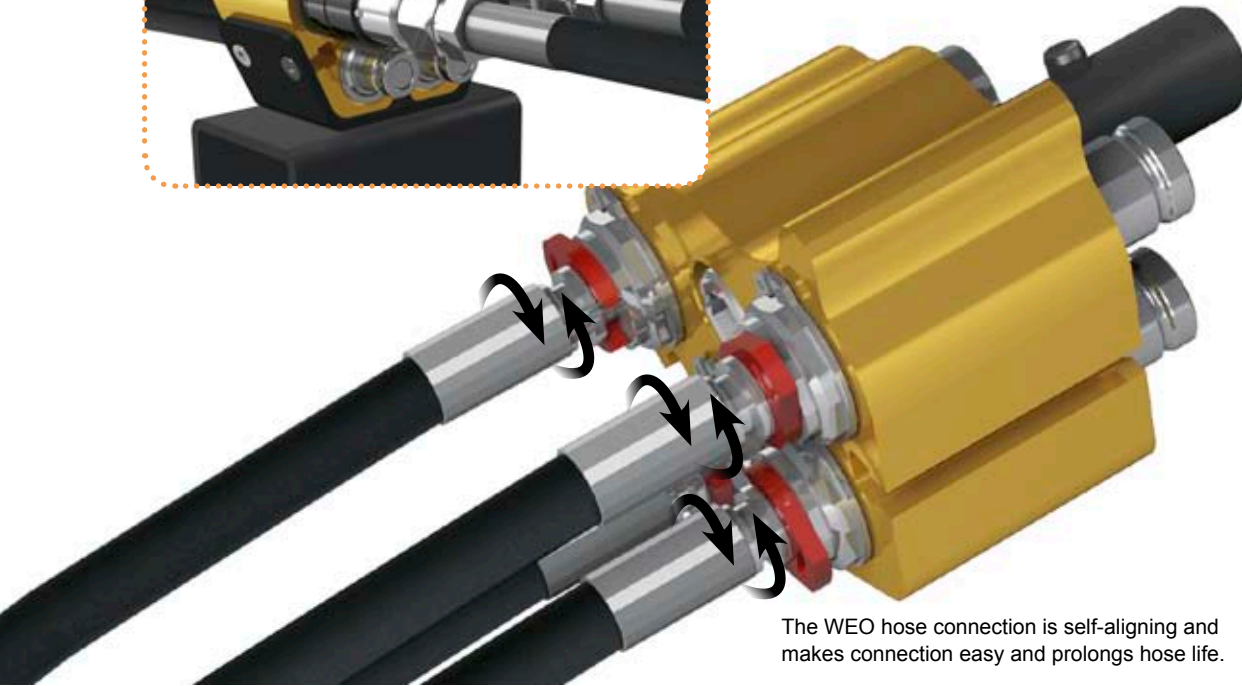

The WEO hose connection is self-aligning and makes connection easy and prolongs hose life.

## Flexibility

**The range** consists of six standard configurations, matching the most frequent application needs. The sizes range for DN 10 to DN 19 combined with two or four ports in each plate (for details on the range see pages 6-7). Each plate can also be equipped with an optional electric connector (available as accessory).

**The innovative design** allows you to use either part of the plate system mounted as the fixed plate without compromising the performance. The mounting bracket is enclosed with the female plate but you can just as easily use it to install the male plate in the application instead.

As an extra advantage when you use the male plate as the fixed installation you can connect standard ISO 16028 flat-face couplings to the Multi-X plate, giving you maximum flexibility to use tools and attachments both with and without a Multi-X plate.

## Performance

**The Multi-X design** allows you to use a working pressure up to 5076 PSI (350 bar) on half the ports simultaneously and the rest of the ports as return lines with a maximum of 725 PSI (50 bar), regardless if you use two or four ports.

The design also offers the possibility to connect the units with residual pressure.

### Residual pressure

1. Up to 5076 PSI (350 bar) residual pressure on the male side and free to drain on the female side.
2. Up to 3625 PSI (250 bar) residual pressure on the female side and free to drain on the male side.
3. Up to 3625 PSI (250 bar) residual pressure on the male side and 145 PSI (10 bar) return resistance on the female side.

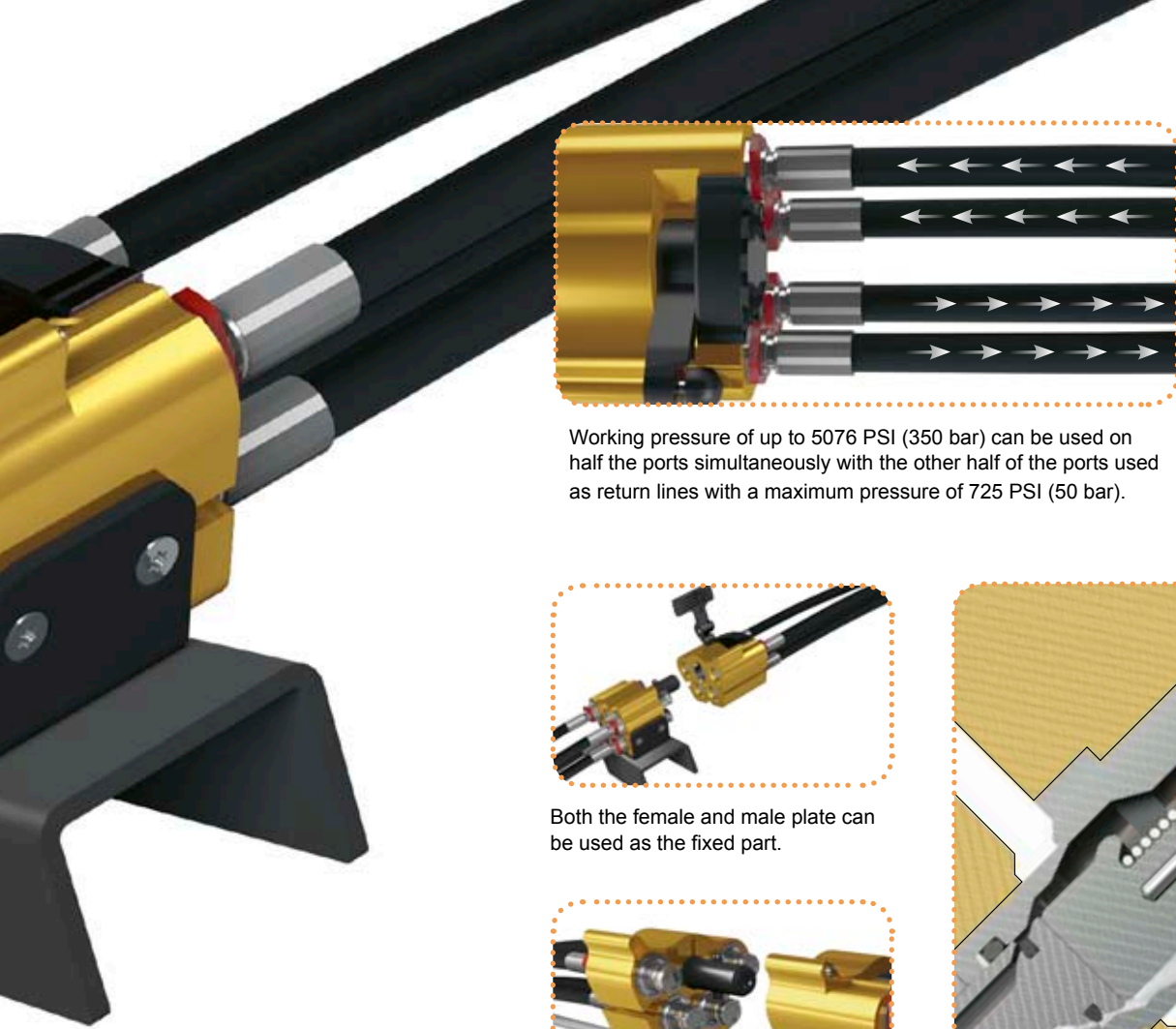

Working pressure of up to 5076 PSI (350 bar) can be used on half the ports simultaneously with the other half of the ports used as return lines with a maximum pressure of 725 PSI (50 bar).



Both the female and male plate can be used as the fixed part.



Electric connectors can easily be attached to each plate.

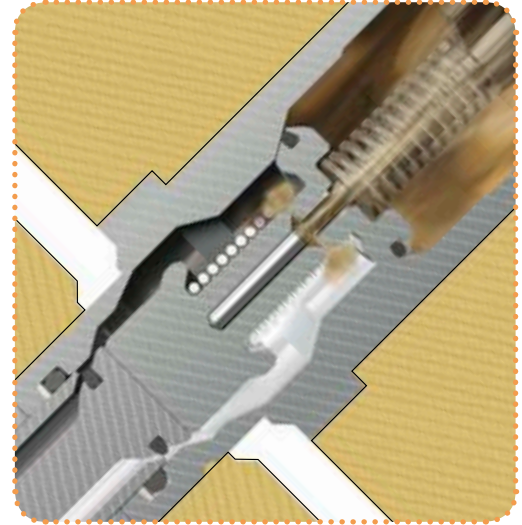

The pressure is punctured without spillage making it simple to connect with residual pressure in the system.

## Connections

The **Multi-X range** is outfitted with WEO Plug-In hose connections, making them both easy to assemble and to connect. Using Plug-In connections provides the Multi-X range with the same outstanding features as the CEJN WEO Range products – self-aligning hose connections that prolongs hose life, minimized downtimes when the need to replace or remove the hose occurs and its minimal space requirements that allows for more compact designs.

Each Multi-X plate comes with **integrated WEO cartridges** for easy installation. Use the WEO Hose connection nipples and ferrules to crimp the nipples directly onto the hose or convert your existing hose to WEO Plug-In with the threaded WEO Nipples (see part numbers page 10).

## Operation

The Multi-X is **easily operated** with one hand on the lever and one hand guiding the moving plate during both connection and disconnection. The ergonomical lever placed perpendicular to the hydraulic lines keeps the **operators hands safe**. The locking button secures the lever when connected and prevents unintentional disconnection.

All Multi-X male plates are equipped with **pressure eliminator nipples** that make it possible to connect the plates also with residual pressure in the system. By puncturing the pressure, without spillage, it allows for a smooth connection even at a high residual pressure (up to 5076 PSI (350 bar)).

The self-aligning WEO connection **removes the torsion** in the hose, a common issue when using ordinary fittings, making it easy to align and connect the plates.

# Multi-X range

## Technical data

- Max. working pressure** ..... 5076 PSI (35 MPa)
- Min. burst pressure** ..... 17 400 PSI (1200 bar)
- Temperature range** ..... -22°F to +212°F (-30°C to +100°C)
- Material female plate** ..... Zinc plated steel, anodized aluminum, zinc, brass
- Material male plate** ..... Zinc plated steel, anodized aluminum, brass
- Material seal** ..... Nitril (NBR)
- Disconnection under pressure** .... To be avoided. Residual pressure can result in recoil effect during disconnection. Always grip the lever firmly.
- Comment** ..... Contact CEJN technical support for recommendations for high impulse applications.
- Disconnection under pressure** .... To be avoided. Residual pressure can result in recoil effect during disconnection. Always grip the lever firmly.
- Comment** ..... Contact CEJN technical support for recommendations for high impulse applications.

CONNECTABILITY CASE NO.		DN10 - 3/8"	DN12.5 - 1/2"	DN19 - 3/4"
1.	Connectable with residual pressure on the male side and free to drain on the female side	5076 PSI	5076 PSI	5076 PSI
2.	Connectable with residual pressure on the female side and free to drain on the male side	3620 PSI	2175 PSI	870 PSI
3.	Connectable with residual pressure on the male side and 1 MPa return pressure on the female side	3620 PSI	3190 PSI	3190 PSI

## Measurements

### FEMALE PLATE

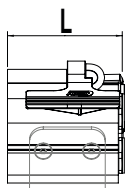
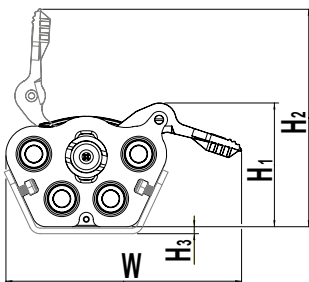

### MALE PLATE

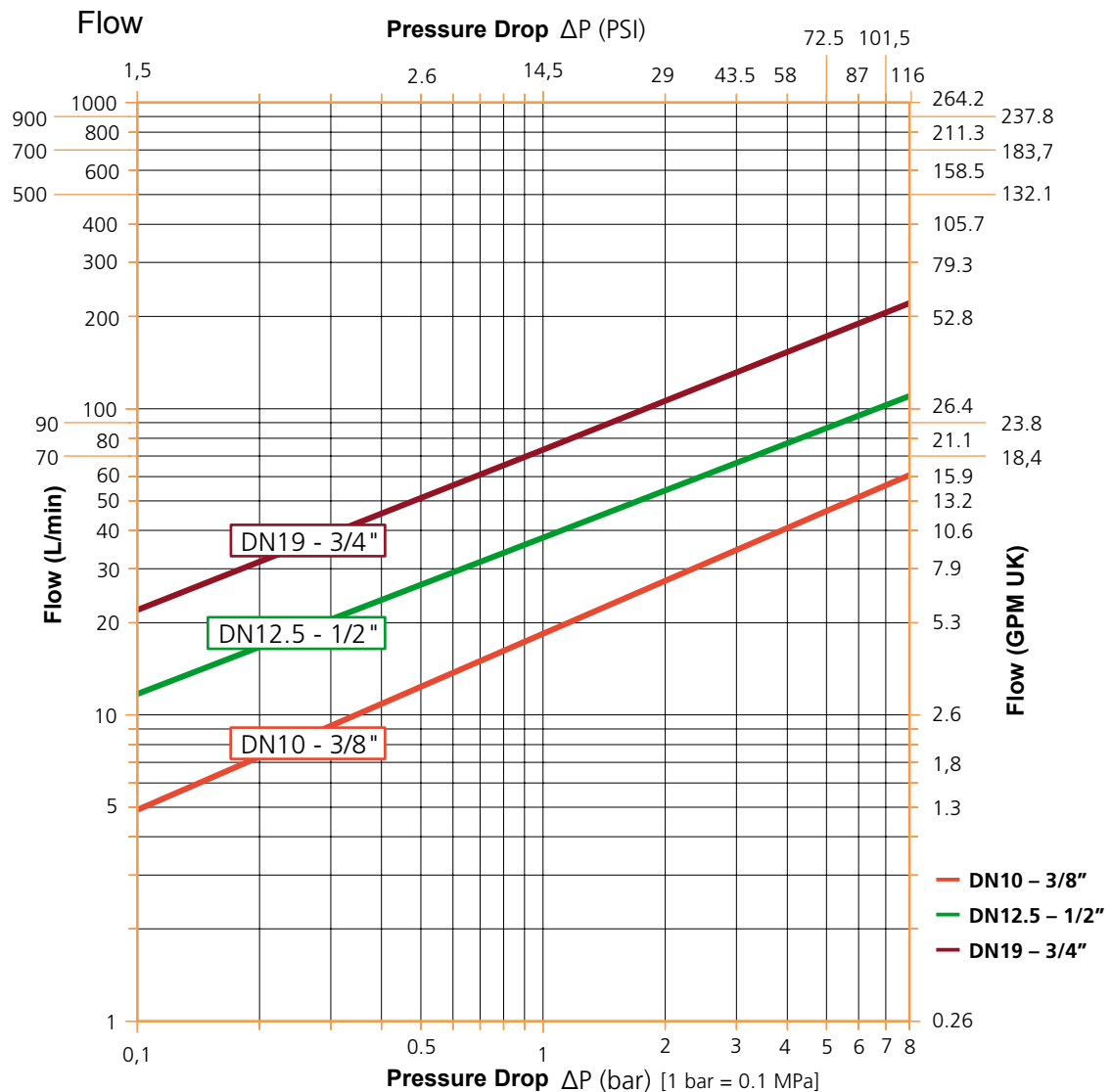
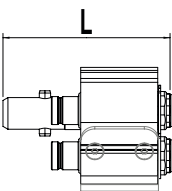
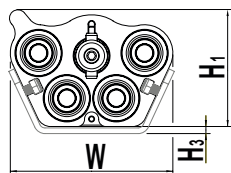

## Multi-X Duo 10

Nominal flow dia..... 3/8" (10 mm)



	Part no	No Ports	Connection	L	W	H1	H2	H3
<b>FEMALE PLATE</b>	10 932 2000	2	WEO 1/2"	83	168	70	138	5
<b>MALE PLATE</b>	10 932 2050	2	WEO 3/8"	116	116	66	-	5

## Multi-X Duo 12.5

Nominal flow dia..... 1/2" (12.5 mm)



	Part no	No Ports	Connection	L	W	H1	H2	H3
<b>FEMALE PLATE</b>	10 932 2001	2	WEO 3/4"	98	176	79	139	5
<b>MALE PLATE</b>	10 932 2051	2	WEO 1/2"	138	132	73	-	5

## Multi-X Duo 19

Nominal flow dia..... 3/4" (19 mm)



	Part no	No Ports	Connection	L	W	H1	H2	H3
<b>FEMALE PLATE</b>	10 932 5002	2	WEO 3/4"	120	214	107	170	5
<b>MALE PLATE</b>	10 932 5052	2	WEO 3/4"	182	179	97	-	5

## Multi-X Quattro 10

Nominal flow dia..... 3/8" (10 mm)



	Part no	No Ports	Connection	L	W	H1	H2	H3
<b>FEMALE PLATE</b>	10 932 3000	4	WEO 1/2"	83	168	88	155	5
<b>MALE PLATE</b>	10 932 3050	4	WEO 3/8"	116	116	83	-	5

## Multi-X Quattro 10/12.5

Nominal flow dia..... 3/8" (10mm)/1/2" (12.5 mm)



	Part no	No Ports	Connection	L	W	H1	H2	H3
<b>FEMALE PLATE</b>	10 932 4000	4	WEO 1/2"+ 3/4"	98	176	99	159	5
<b>MALE PLATE</b>	10 932 4050	4	WEO 3/8"+ 1/2"	138	132	93	-	5

## Multi-X Quattro 12.5

Nominal flow dia..... 1/2" (12.5 mm)



	Part no	No Ports	Connection	L	W	H1	H2	H3
<b>FEMALE PLATE</b>	10 932 4001	4	WEO 3/4"	98	176	99	159	5
<b>MALE PLATE</b>	10 932 4051	4	WEO 1/2"	138	132	93	-	5

## Multi-X Quattro 12.5/19

Nominal flow dia..... 1/2" (12.5 mm)/3/4" (19mm)



	Part no	No Ports	Connection	L	W	H1	H2	H3
<b>FEMALE PLATE</b>	10 932 5000	4	WEO 3/4"	120	214	107	170	5
<b>MALE PLATE</b>	10 932 5050	4	WEO 1/2"+ 3/4"	182	179	97	-	5

All measurements are in mm.

# Multi-X Accessories

## Multi-X Electric Connector kits

Multi-X can be fitted with an electric connector kit on both the male and the female plate. The kits contain all necessary components as well as assembly instructions and dust caps.

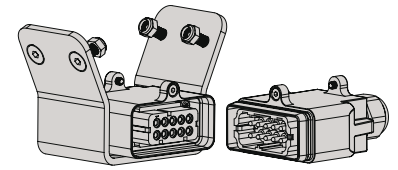

**Connections**..... 10 + ground  
**Voltage**..... 250 V  
**Current**..... 16 Amp.

	Suitable for	Part no	L	W	H1	H2	H3
<b>ELECTRIC CONNECTOR KIT FOR FEMALE PLATE</b>	Multi-X Duo 10	10 932 0010	83	168	101	169	5
	Multi-X Duo 12.5	10 932 0011	98	176	110	170	5
	Multi-X Quattro 10	10 932 0012	83	168	119	186	5
	Multi-X Quattro 10/12.5	10 932 0013	98	176	130	190	5
	Multi-X Quattro 12.5	98	176	130	190	5	
	Multi-X Quattro 12.5/19	10 932 0015	120	214	138	201	5
<b>ELECTRIC CONNECTOR KIT FOR MALE PLATE</b>	Multi-X Duo 10	10 932 0050	116	116	97	-	5
	Multi-X Duo 12.5	10 932 0051	138	132	104	-	5
	Multi-X Quattro 10	10 932 0052	116	116	114	-	5
	Multi-X Quattro 10/12.5	10 932 0053	138	132	124	-	5
	Multi-X Quattro 12.5					-	
	Multi-X Quattro 12.5/19	10 932 0055	182	179	128	-	5

Measurements refer to outside dimensions of the Multi-X plate with the electrical connector kit installed. All measurements are in mm.

## Multi-X Aluminum Cover/Parking Dock

The aluminum covers can be used as heavy duty protection when the plates are disconnected. The covers can also easily be mounted and used as fixed parking docks. Covers are only available for plates without electric connectors (can be used with the electric connector but will not cover the electric pins).

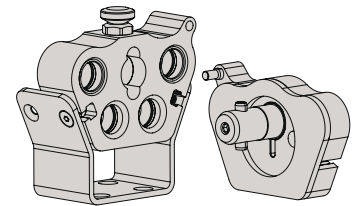

**Material**..... Aluminum

	Suitable for	Part no
<b>ALUMINUM COVER/PARKING DOCK FOR FEMALE PLATE</b>	Multi-X Duo 10	10 932 1020
	Multi-X Duo 12.5	10 932 1021
	Multi-X Quattro 10	10 932 1022
	Multi-X Quattro 10/12.5	10 932 1023
	Multi-X Quattro 12.5	10 932 1023
	Multi-X Quattro 12.5/19	10 932 1025
<b>ALUMINUM COVER/PARKING DOCK FOR MALE PLATE</b>	Multi-X Duo 10	10 932 1070
	Multi-X Duo 12.5	10 932 1071
	Multi-X Quattro 10	10 932 1072
	Multi-X Quattro 10/12.5	10 932 1073
	Multi-X Quattro 12.5	10 932 1073
	Multi-X Quattro 12.5/19	10 932 1075

## Multi-X Dust caps

The plastic dust caps are enclosed with each plate, but can also be purchased separately.

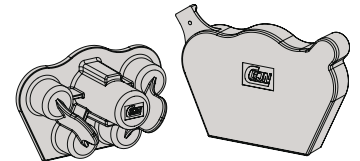

**Material**..... Soft PVC



	Suitable for	Part no		Suitable for	Part no
<b>DUST CAPS FOR FEMALE PLATE</b>	Multi-X Duo 10	09 932 1000	<b>DUST CAPS FOR MALE PLATE</b>	Multi-X Duo 10	09 932 1050
	Multi-X Duo 12.5	09 932 1002		Multi-X Duo 12.5	09 932 1052
	Multi-X Quattro 10	09 932 1001		Multi-X Quattro 10	09 932 1051
	Multi-X Quattro 10/12.5	09 932 1003		Multi-X Quattro 10/12.5	09 932 1053
	Multi-X Quattro 12.5	09 932 1003		Multi-X Quattro 12.5	09 932 1053
	Multi-X Quattro 12.5/19	09 932 1005		Multi-X Quattro 12.5/19	09 932 1055
<b>DUST CAPS FOR FEMALE PLATE WITH ELECTRIC CONNECTOR</b>	Multi-X Duo 10	09 932 1010	<b>DUST CAPS FOR MALE PLATE WITH ELECTRIC CONNECTOR</b>	Multi-X Duo 10	09 932 1060
	Multi-X Duo 12.5	09 932 1012		Multi-X Duo 12.5	09 932 1062
	Multi-X Quattro 10	09 932 1011		Multi-X Quattro 10	09 932 1061
	Multi-X Quattro 10/12.5	09 932 1013		Multi-X Quattro 12.5	09 932 1063
	Multi-X Quattro 12.5	09 932 1013		Multi-X Quattro 10/12.5	09 932 1063
	Multi-X Quattro 12.5/19	09 932 1015		Multi-X Quattro 12.5/19	09 932 1065



# Multi-X Spare Parts

## Multi-X Coupling and Nipple kits

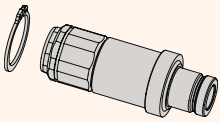
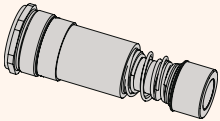
The couplings and nipples in the Multi-X plates can be replaced. The nipple kit contains nipple and retaining ring. The coupling kit contains a complete set of parts for replacement of one coupling. The seal kit contains one O-ring and one backup ring to replace the front seal on the nipple.

	DN size	Suitable for	Part no	WEO connection
<b>NIPPLE KIT</b> 	DN 10	Multi-X Duo 10 Multi-X Quattro 10 Multi-X Quattro 10/12.5	10 364 6904	3/8"
	DN 12.5	Multi-X Quattro 12.5 Multi-X Quattro 10/12.5 Multi-X Quattro 12.5/19	10 564 6905	1/2"
	DN 19	Multi-X Quattro 12.5/19	10 764 6901	3/4"
<b>COUPLING KIT</b> 	DN 10	Multi-X Duo 10 Multi-X Quattro 10	10 365 1905	1/2"
	DN 12.5	Multi-X Quattro 10/12.5	10 365 1906	1/2"
		Multi-X Quattro 12.5 Multi-X Quattro 10/12.5 Multi-X Quattro 12.5/19	10 565 1907	3/4"
	DN 19	Multi-X Quattro 12.5/19	10 765 1901	3/4"
	<b>SEAL KITS</b> 	DN 10	Nipple DN10	10 365 4900
DN 12.5		Nipple DN12.5	10 565 4900	-
DN 19		Nipple DN19	10 765 4900	-

## Multi-X Mounting Bracket

The mounting bracket is enclosed with all female Multi-X plates, but can be used with both the female or male plate.

**Material** ..... Powder coated steel

## Multi-X Spare Parts

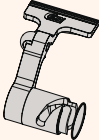
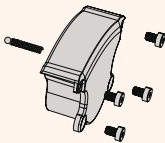
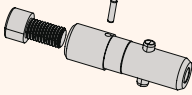
	Suitable for	Part no
<b>LEVER ASSEMBLY</b> 	Multi-X Duo 10 Multi-X Quattro 10	10 932 4960
	Multi-X Duo 12.5 Multi-X Quattro 12.5 Multi-X Quattro 10/12.5	10 932 4970
	Multi-X Quattro 12.5/19	10 932 4980
	Multi-X Duo 10 Multi-X Quattro 10	10 932 4961
<b>BACK LID KIT</b> 	Multi-X Duo 12.5 Multi-X Quattro 12.5 Multi-X Quattro 10/12.5	10 932 4971
	Multi-X Quattro 12.5/19	10 932 4981
	Multi-X Duo 10 Multi-X Quattro 10	10 932 4962
<b>CENTER BOLT KIT</b> 	Multi-X Duo 12.5 Multi-X Quattro 12.5 Multi-X Quattro 10/12.5	10 932 4972
	Multi-X Quattro 12.5/19	10 932 4982

	Suitable for	Part no	
<b>MOUNTING BRACKET FOR FEMALE/MALE PLATES</b>	Multi-X Duo 10 Multi-X Quattro 10 Multi-X Duo 12.5	10 932 4963 10 932 4965 10 932 4973	
	Multi-X Quattro 12.5 Multi-X Quattro 10/12.5	10 932 4975	
	Multi-X Quattro 12.5/19	10 932 4985	
	<b>MOUNTING BRACKET FOR FEMALE/MALE PLATES WITH ELECTRICAL CONNECTOR</b>	Multi-X Duo 10 Multi-X Quattro 10 Multi-X Duo 12.5	10 932 4964 10 932 4966 10 932 4974
		Multi-X Quattro 12.5 Multi-X Quattro 10/12.5	10 932 4976
Multi-X Quattro 12.5/19		10 932 4986	

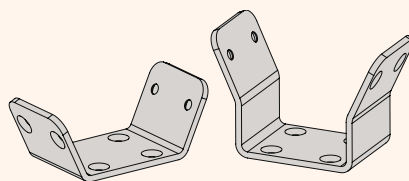

# Choose connection

## WEO-nipples with thread connections

Multi-X art nr. and title	Multi-X connection	Choose your connection	WEO art nr.
10 932 2050 Duo 10, male plate	WEO 3/8"	BSP 3/8" fem	14 721 0606
10 932 3050 Quattro 10, male plate		BSP 1/2" fem	14 721 0608
		JIC 9/16-18	14 727 0609
		JIC 3/4"-16	14 727 0612
10 932 2000 Duo 10, female plate	WEO 1/2"	BSP 3/8" fem	14 721 0806
10 932 2051 Duo 12,5, male plate		BSP 1/2" fem	14 721 0848
10 932 3000 Quattro 10, female plate		JIC 9/16-18	14 727 0809
10 932 4051 Quattro 12,5, male plate		JIC 3/4"-16	14 727 0812
10 932 2001 Duo 12,5, female plate	WEO 3/4"	BSP 1/2" fem	14 721 1208
10 932 4001 Quattro 12,5, female plate		BSP 3/4" fem	14 721 1212
10 932 5000 Quattro 12,5/19, female plate		JIC 1 1/16"-12	14 727 1217
10 932 5002 Duo 19, female plate			
10 932 5052 Duo 19, male plate			
10 932 4050 Quattro 10/12,5, male plate	WEO 3/8"	BSP 3/8" fem	14 721 0606
		BSP 1/2" fem	14 721 0608
		JIC 9/16-18	14 727 0609
		JIC 3/4"-16	14 727 0612
	WEO 1/2"	BSP 3/8" fem	14 721 0806
		BSP 1/2" fem	14 721 0848
		JIC 9/16-18	14 727 0809
		JIC 3/4"-16	14 727 0812
10 932 4000 Quattro 10/12,5, female plate	WEO 1/2"	BSP 3/8" fem	14 721 0806
10 932 5050 Quattro 12,5/19, male plate		BSP 1/2" fem	14 721 0848
	WEO 3/4"	JIC 9/16-18	14 727 0809
		JIC 3/4"-16	14 727 0812
		BSP 1/2" fem	14 721 1208
		BSP 3/4" fem	14 721 1212
		JIC 1 1/16"-12	14 727 1217



Series 721 - WEO-nipples, female BSP-thread



Series 727 - WEO-nipples, male JIC-thread 37°

## WEO-nipples with hydraulic hose connection

Multi-X art nr. and title	Multi-X con.	Hose con.	Straight nipple	WEO-nipple 45°	WEO-nipple 90°
10 932 2050 Duo 10, male plate	WEO 3/8"	DN06 (1/4")	14 710 0604		
10 932 3050 Quattro 10, male plate		DN10 (3/8")	14 710 0606	14 712 0606	14 714 0606
10 932 2000 Duo 10, female plate	WEO 1/2"	DN10 (3/8")	14 710 0806		14 714 0806
10 932 2051 Duo 12,5, male plate		DN12 (1/2")	14 710 0808	14 712 0808	14 714 0808
10 932 3000 Quattro 10, female plate					
10 932 4051 Quattro 12,5, male plate					
10 932 2001 Duo 12,5, female plate	WEO 3/4"	DN12 (1/2")	14 710 1208		
10 932 4001 Quattro 12,5, female plate		DN20 (3/4")	14 710 1212		
10 932 5000 Quattro 12,5/19, female plate					
10 932 5002 Duo 19, female plate					
10 932 5052 Duo 19, male plate					
10 932 4050 Quattro 10/12,5, male plate	WEO 3/8"	DN06 (1/4")	14 710 0604		
		DN10 (3/8")	14 710 0606	14 712 0606	14 714 0606
	WEO 1/2"	DN10 (3/8")	14 710 0806		14 714 0806
		DN12 (1/2")	14 710 0808	14 712 0808	14 714 0808
10 932 4000 Quattro 10/12,5, female plate	WEO 1/2"	DN10 (3/8")	14 710 0806		14 714 0806
10 932 5050 Quattro 12,5/19, male plate		DN12 (1/2")	14 710 0808	14 712 0808	14 714 0808
	WEO 3/4"	DN12 (1/2")	14 710 1208		
		DN20 (3/4")	14 710 1212		





*The Global*  
**Quick Connect Specialist**

